

STRAIGHT D SHACKLE WITH SCREW PIN

316 STAINLESS STEEL



Import



Precision
Cast

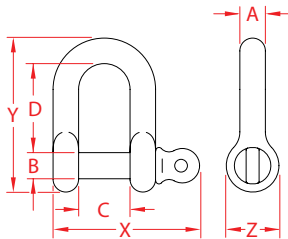

ITEM	A (size)	B	C	D	X (height)	Y (length)	Z (width)	WLL (lb)	WT (lb)	PACKAGING TYPE	EACH (qty)	INNER (qty)	CARTON (qty)	UPC
S0115-0004	5/32"	0.15"	0.31"	0.55"	1.02"	0.93"	0.31"	200	0.02	POLYBAG	1	10	1500	791506028796
S0115-0005	3/16"	0.19"	0.45"	0.76"	1.27"	1.27"	0.41"	500	0.04	POLYBAG	1	10	800	791506028802
S0115-0006	1/4"	0.23"	0.48"	0.85"	1.48"	1.42"	0.49"	750	0.06	POLYBAG	1	10	500	791506028819
S0115-0008	5/16"	0.31"	0.67"	1.11"	1.95"	1.90"	0.65"	1,000	0.14	POLYBAG	1	10	200	791506028826
S0115-0010	3/8"	0.39"	0.78"	1.37"	2.33"	2.32"	0.78"	1,200	0.25	POLYBAG	1	10	100	791506028840
S0115-0012	15/32"	0.46"	0.95"	1.66"	2.78"	2.76"	0.93"	1,500	0.43	POLYBAG	1	10	60	791506028864
S0115-0013	1/2"	0.54"	1.09"	1.84"	3.19"	3.18"	1.07"	2,500	0.66	POLYBAG	1	1	50	791506028871
S0115-0016	5/8"	0.61"	1.25"	2.01"	3.68"	3.53"	1.22"	3,000	0.97	POLYBAG	1	1	30	791506028888
S0115-0020	3/4"	0.74"	1.46"	2.57"	4.42"	4.41"	1.46"	4,000	1.68	POLYBAG	1	1	20	791506028895
S0115-0022	7/8"	0.86"	1.70"	2.92"	4.66"	5.11"	1.66"	5,000	2.48	POLYBAG	1	1	10	791506028901
S0115-0025	1"	0.96"	1.95"	3.45"	5.31"	5.92"	1.91"	6,000	3.63	POLYBAG	1	1	10	791506028918
S0115-0032	1-1/4"	1.25"	2.50"	4.35"	7.18"	7.63"	2.54"	9,000	8.21	POLYBAG	1	1	4	791506028925

NOTE:
ALL DIMENSIONS ARE NOMINAL (+/- 3%) AND ARE SUBJECT TO CHANGE WITHOUT NOTICE.